

DIMAGGIO  
AT METRO BALLPARK

*Pricing*  
GUIDE

**SIMPLY LOOK OUT YOUR WINDOW AND CREATE MEMORIES THAT  
WILL LAST FOR A LIFETIME.**

THIS GUIDE PROVIDES PRELIMINARY PRICING BASED ON UNIT LAYOUT, SIZE AND LOCATION. EACH UNIT INCLUDES ONE COVERED PARKING STALL AND BASE FINISH. FINAL PRICE WILL BE DETERMINED WHEN PURCHASE CONTRACT IS SIGNED. \$2,500 DEPOSIT REQUIRED TO SECURE YOUR SUITE.

UPGRADED FINISHING PACKAGES WILL BE AVAILABLE (COMING SOON)

JOE'S GETAWAY LAYOUT IS AVAILABLE WHEN PURCHASING "SUITE 56" AND "THE CLIPPER" TOGETHER (1,815 SQ FT).

*Secure your Suite: visit [thedimaggio.com](http://thedimaggio.com)*

**DIMAGGIO**  
AT METRO BALLPARK

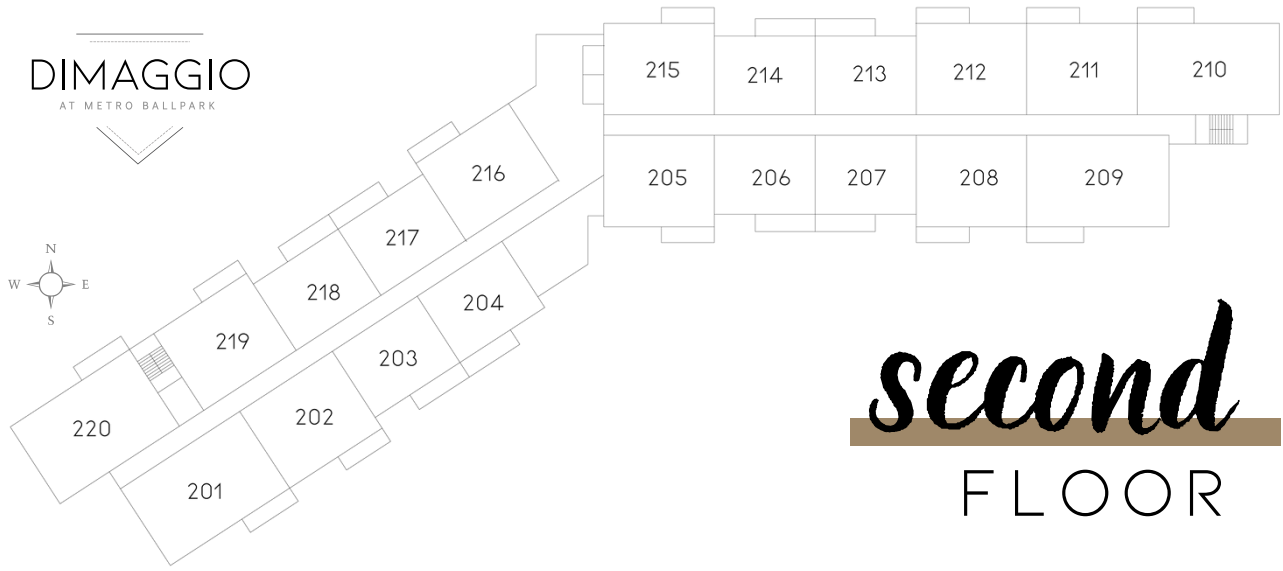

# *second* FLOOR

	201	MARILYN'S TOUCH	1,350 SQ FT	\$598,050
	202	THE CLIPPER	1,015 SQ FT	\$431,375
	203	SUITE 56	800 SQ FT	\$340,000
	204	SUITE 56	800 SQ FT	\$356,000
	205	THE CLIPPER	1,015 SQ FT	\$451,675
	206	SUITE 56	800 SQ FT	\$340,000
	207	SUITE 56	800 SQ FT	\$340,000
	208	THE CLIPPER	1,015 SQ FT	\$431,375
	209	MARILYN'S TOUCH	1,350 SQ FT	\$598,050
	210	MARILYN'S TOUCH	1,350 SQ FT	\$587,250
	211	THE CLIPPER	1,015 SQ FT	\$404,985
	212	THE CLIPPER	1,015 SQ FT	\$404,985
	213	SUITE 56	800 SQ FT	\$319,200
	214	SUITE 56	800 SQ FT	\$319,200
	215	THE CLIPPER	1,015 SQ FT	\$431,375
	216	THE CLIPPER	1,015 SQ FT	\$431,375
	217	SUITE 56	800 SQ FT	\$319,200
	218	SUITE 56	800 SQ FT	\$319,200
	219	THE CLIPPER	1,015 SQ FT	\$404,985
	220	MARILYN'S TOUCH	1,350 SQ FT	\$597,250

DISCLAIMER: PRICING INCLUDES ONE GROUND LEVEL PARKING STALL. FINAL PRICE WILL BE DETERMINED WHEN PURCHASE CONTRACT IS SIGNED. \$2,500 DEPOSIT REQUIRED TO SECURE YOUR SUITE.

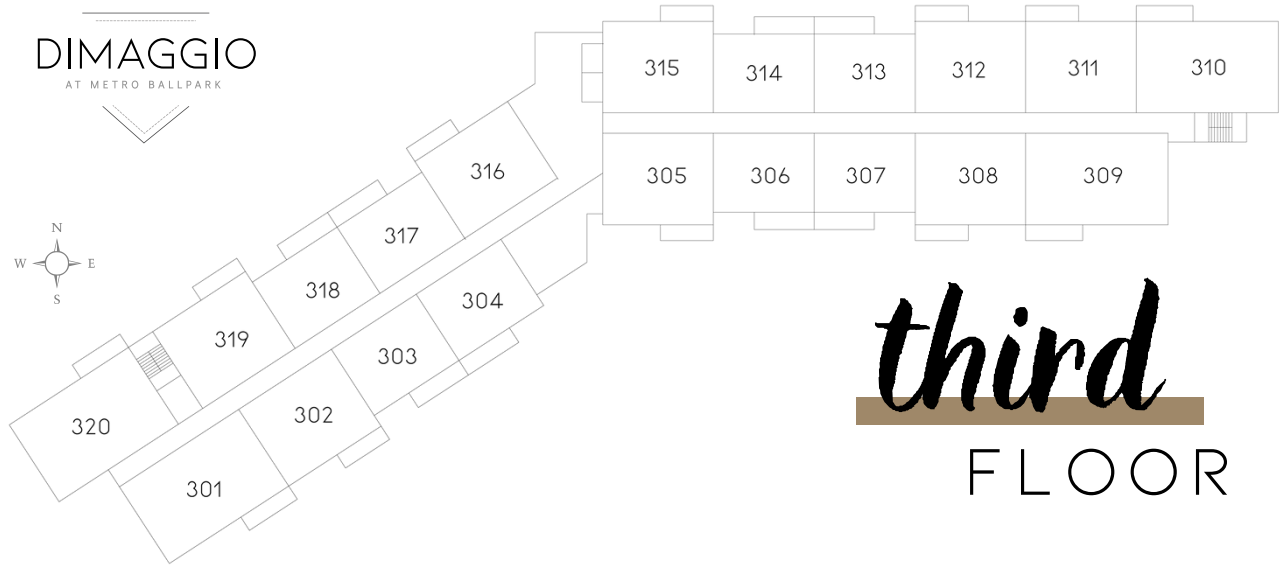

# *third* FLOOR

	301	MARILYN'S TOUCH	1,350 SQ FT	\$645,894
	302	THE CLIPPER	1,015 SQ FT	\$465,885
	303	SUITE 56	800 SQ FT	\$367,200
	304	SUITE 56	800 SQ FT	\$384,480
	305	THE CLIPPER	1,015 SQ FT	\$487,809
	306	SUITE 56	800 SQ FT	\$367,200
	307	SUITE 56	800 SQ FT	\$367,200
	308	THE CLIPPER	1,015 SQ FT	\$465,885
	309	MARILYN'S TOUCH	1,350 SQ FT	\$645,894
	310	MARILYN'S TOUCH	1,350 SQ FT	\$634,230
	311	THE CLIPPER	1,015 SQ FT	\$437,384
	312	THE CLIPPER	1,015 SQ FT	\$437,384
	313	SUITE 56	800 SQ FT	\$344,736
	314	SUITE 56	800 SQ FT	\$344,736
	315	THE CLIPPER	1,015 SQ FT	\$465,885
	316	THE CLIPPER	1,015 SQ FT	\$465,885
	317	SUITE 56	800 SQ FT	\$344,736
	318	SUITE 56	800 SQ FT	\$344,736
	319	THE CLIPPER	1,015 SQ FT	\$437,384
	320	MARILYN'S TOUCH	1,350 SQ FT	\$634,230

DISCLAIMER: PRICING INCLUDES ONE GROUND LEVEL PARKING STALL. FINAL PRICE WILL BE DETERMINED WHEN PURCHASE CONTRACT IS SIGNED. \$2,500 DEPOSIT REQUIRED TO SECURE YOUR SUITE.

**DIMAGGIO**  
AT METRO BALLPARK

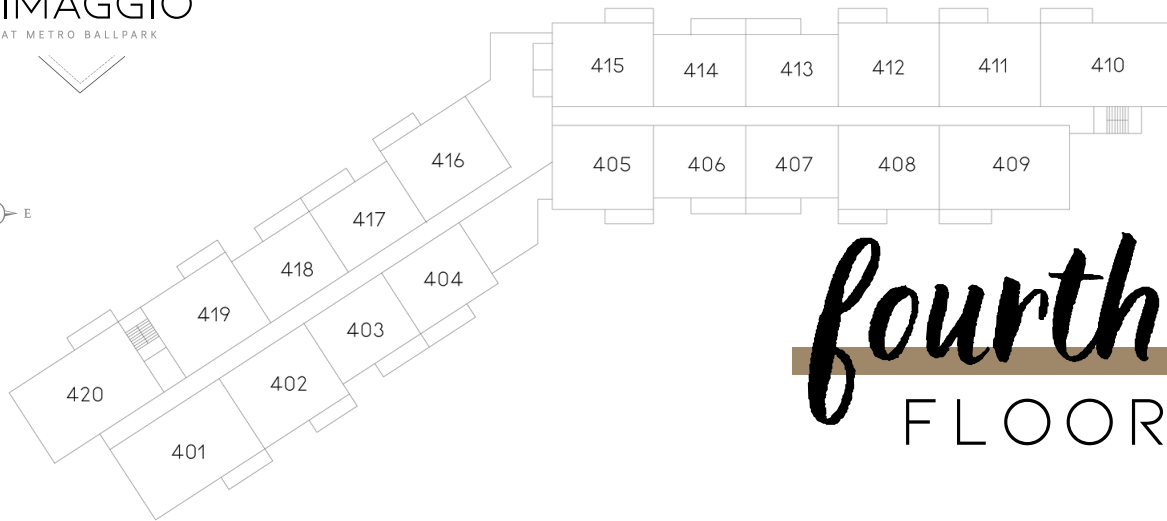

*fourth*  
FLOOR

	401	MARILYN'S TOUCH	1,350 SQ FT	\$697,566
	402	THE CLIPPER	1,015 SQ FT	\$503,156
	403	SUITE 56	800 SQ FT	\$396,576
	404	SUITE 56	800 SQ FT	\$415,238
	405	THE CLIPPER	1,015 SQ FT	\$526,834
	406	SUITE 56	800 SQ FT	\$396,576
	407	SUITE 56	800 SQ FT	\$396,576
	408	THE CLIPPER	1,015 SQ FT	\$503,156
	409	MARILYN'S TOUCH	1,350 SQ FT	\$697,566
	410	MARILYN'S TOUCH	1,350 SQ FT	\$684,968
	411	THE CLIPPER	1,015 SQ FT	\$472,375
	412	THE CLIPPER	1,015 SQ FT	\$472,375
	413	SUITE 56	800 SQ FT	\$372,315
	414	SUITE 56	800 SQ FT	\$372,315
	415	THE CLIPPER	1,015 SQ FT	\$503,156
	416	THE CLIPPER	1,015 SQ FT	\$503,156
	417	SUITE 56	800 SQ FT	\$372,315
	418	SUITE 56	800 SQ FT	\$372,315
	419	THE CLIPPER	1,015 SQ FT	\$472,375
	420	MARILYN'S TOUCH	1,350 SQ FT	\$684,968

DISCLAIMER: PRICING INCLUDES ONE GROUND LEVEL PARKING STALL. FINAL PRICE WILL BE DETERMINED WHEN PURCHASE CONTRACT IS SIGNED. \$2,500 DEPOSIT REQUIRED TO SECURE YOUR SUITE.

**DIMAGGIO**  
AT METRO BALLPARK



*fifth*  
FLOOR

	501	MARILYN'S TOUCH	1,350 SQ FT	\$837,079
	502	THE CLIPPER	1,015 SQ FT	\$578,629
	503	SUITE 56	800 SQ FT	\$456,062
	504	SUITE 56	800 SQ FT	\$477,524
	505	THE CLIPPER	1,015 SQ FT	\$605,859
	506	SUITE 56	800 SQ FT	\$456,062
	507	SUITE 56	800 SQ FT	\$456,062
	508	THE CLIPPER	1,015 SQ FT	\$578,629
	509	MARILYN'S TOUCH	1,350 SQ FT	\$837,079
	510	MARILYN'S TOUCH	1,350 SQ FT	\$821,962
	511	THE CLIPPER	1,015 SQ FT	\$543,231
	512	THE CLIPPER	1,015 SQ FT	\$543,231
	513	SUITE 56	800 SQ FT	\$428,162
	514	SUITE 56	800 SQ FT	\$428,162
	515	THE CLIPPER	1,015 SQ FT	\$578,629
	516	THE CLIPPER	1,015 SQ FT	\$578,629
	517	SUITE 56	800 SQ FT	\$428,162
	518	SUITE 56	800 SQ FT	\$428,162
	519	THE CLIPPER	1,015 SQ FT	\$543,231
	520	MARILYN'S TOUCH	1,350 SQ FT	\$821,962

DISCLAIMER: PRICING INCLUDES ONE GROUND LEVEL PARKING STALL. FINAL PRICE WILL BE DETERMINED WHEN PURCHASE CONTRACT IS SIGNED. \$2,500 DEPOSIT REQUIRED TO SECURE YOUR SUITE.